



840
SCANALIST

CH1 Chicago Data Center

A fully modernized data center environment providing dedicated power at scale, massive connectivity, operational flexibility options, rapid deployment and the best on-site expertise and support.



serverfarm™



Located in the
heart of Chicago.

Photo by MILLER + MILLER Architectural Photography

Executive Summary

A fully modernized 38MVA data center environment providing dedicated power at scale, massive connectivity, operational flexibility options, rapid deployment of customizable physical spaces with the best on-site expertise and support all wrapped in a services delivery platform that lets you run your data center as a cloud.

Whatever is on your data center wish list – it can be met within the Serverfarm CH1 840 South Canal Street Chicago facility.

Whatever is on your
data center wish list,
it can be met.

CONTENTS

4

Chicago – Data Center Metro

6

The CH1 840 S Canal Street Building

7

SF CH1 Capacity

8

SF CH1 Power
Network

9

Customer Benefits

10

SF CH1 Services

11

InCommand Services

12

About Serverfarm
Contact



Chicago is our kind of town

SF CH1 – The data center at the heart of the Chicago metro

The Chicago metro is a top three US data center market. For Serverfarm and our customers, our central Chicago data center location gives us a distinct advantage.

Being in any large city location is vital. By being close to Chicago's commercial and financial centers, our 840 S Canal Street data center provides local, national and international businesses with significant fiber connectivity and proximity benefits such as lower latency and redundancy.



Chicago metro is a top 3 US data center market.

Chicago Economy Breakdown

Chicago has one of the world's largest and most diversified economies, with more than four million employees and generating an annual gross regional product (GRP) of over \$698 billion.

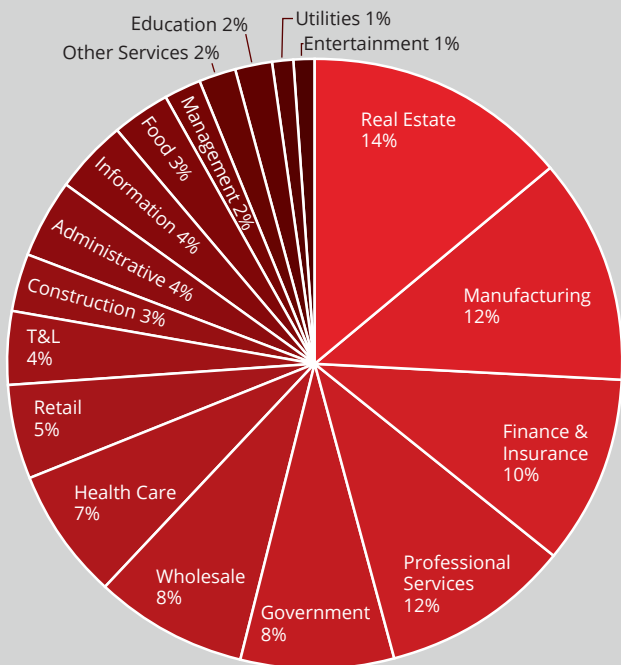



Serverfarm CH1 already provides large edge interfaces with sustainable power for cloud scale operators, reliable connectivity for national service providers, and low latency connections for major finance houses.

With vast amounts of curbside fiber running past the front door, CH1 offers the connectivity options and wide choice from the large and diverse Chicago carrier community.

Access to local and long-distance carriers.

Access to local and long-distance carriers through 13 different providers on-site for cross connect, metro connect, and internet exchange connectivity is available. Also available is dark fiber access linking to major internet exchanges including direct access to 350 East Cermak – the largest exchange in the US Midwest. A central location also removes latency concerns from the equation.

Just as data demands fast transport infrastructure, so people want to move around with as little friction as possible. Major road and rail transport hubs are within a few minutes walking distance of SF CH1 providing fast connections to Chicago's major airport hubs.

The CH1 840 S Canal Street Building



Photo by MILLER + MILLER Architectural Photography

A multi-story data center which has been modernized with the latest Mechanical and Electrical infrastructure, SF CH1 is located in a vibrant locality undergoing cultural rebirth and commercial regeneration. This includes the development of a 2M-square-foot retail center just nearby.

Expert engineering
design and renovation.

Thanks to Serverfarm's unique approach to realizing the potential of assets, SF CH1 underwent expert infrastructure engineering design and renovation.

This resulted in a six story 134,000 sq ft data center comprising a fully accessible vertical facility with high ceiling clearances.

SF CH1 now presents as a completely modern facility matching the performance, reliability and availability of any new build.

Added benefits include the proximity advantages of its central location and the sustainability benefits of having avoided the excessive **embodied carbon cost** often associated with large new build projects.

There is also customizable office space available with great views of the city skyline and local eating and shopping amenities within walking distance.



See our independent report on how Serverfarm's CH1 modernization delivered a lower embodied carbon footprint when evaluated against a new build of comparable capacity.

[Click here to read.](#)

SF CH1 Capacity

The building itself provides six floors of private physical IT white space. Unlike other data centers, SF CH1 infrastructure design enables flexible provision of capacity within halls and across floors.

Capacity can be flexibly deployed on a single story within a particular hall or across several floors. Each technical space can accommodate 2x2MW of capacity. The design allows for 1-2MW roll out on half a single floor or 4-5MW across several different floors.

With an immediate 2MW available for those with rapid deployment requirements, 500kW-750kW can be

Custom & agile space
rapidly available.

provided in as little as 30 days. Blocks of 2MW per customer can be quickly built out.

Flexible design options for the floor capacity provide the customization and agility that is baked into Serverfarm’s thinking.



SF CH1 Power



Access to renewable power sources



Power originates from 4 separate substations



Power provided via 12 diverse feeds



High reliability and efficient design options

38MVA

high tension power secured

20MW

critical load capacity

Network

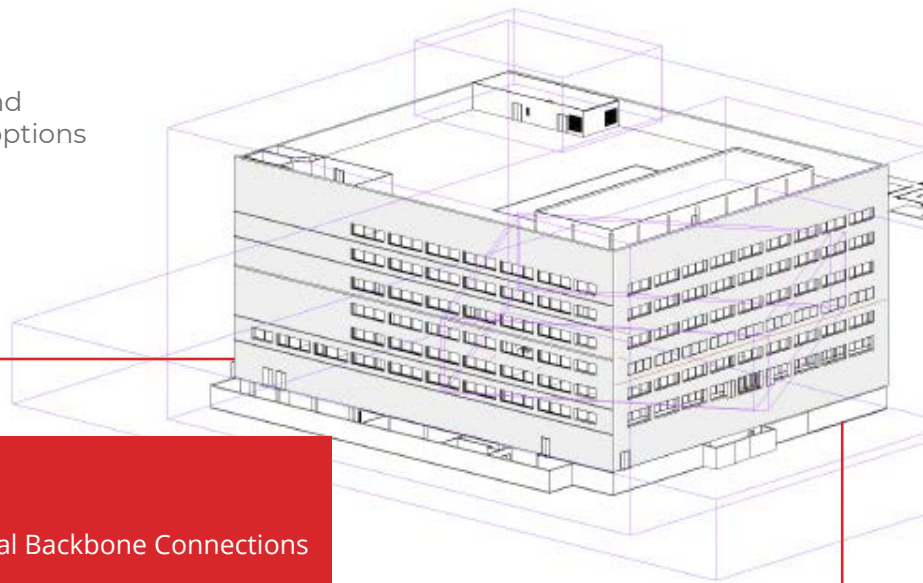

Available Connections

- Cross Connect
- National and International Backbone Connections
- Metro Connect
- Internet Exchange Connect

- Directly available connectivity to 13 different curbside carriers
- Direct access to cloud providers
- Private low premium cost effective Dark Fiber connectivity to 350 E Cermak available
- Delivers further low latency advantages because of how fiber enters the building
- With its global InCommand NOC on-site at CH1, Serverfarm provides Chicago customers with unique local carrier market knowledge

Available Carriers

zayo



Level(3)
COMMUNICATIONS



CenturyLink

verizon

US SIGNAL

CROWN CASTLE

sunesys

cogent

windstream

packetfabric

peerless network

Customer Benefits

Serverfarm CH1 customers enjoy a range of benefits unmatched by any other Chicago metro data center operator.

SF CH1 is ideal for large cloud operators thanks to its capital efficient initial deployment options which scale quickly in response to demand. Capacity and ongoing operations are delivered with sustainability as a primary goal. This includes flexible power provision, maximized efficiency and direct access to renewable power generation.

For commercial colocation firms, cross connects between platforms and onto public cloud and wider connectivity to financial and internet exchanges at cost effective rates create ideal environments.

With diverse vertical markets such as healthcare, finance, manufacturing and technology operating at scale in the Chicago and the surrounding region,

SF CH1 provides power, space and support to meet every enterprise data center objective.

With decades of digital commercial property experience combined with unrivalled levels of technical and engineering expertise, SF CH1 at 840 South Canal Street is an ultra-modern data center facility built around strong flexible economics and competitive cost structures for cloud, commercial and enterprise operators.



Tax Incentives and Benefits

Serverfarm customers at our CH1 data center are eligible to participate in the Illinois sales tax exemption of 10.25% applicable to IT equipment, software and one-time costs associated with installation and deployment thanks to the Illinois Department of Commerce and Economic Opportunity (ILDCEO).

Serverfarm CH1 customers are also eligible for the construction employment tax credit of 20% of wages paid for construction workers on data center projects. Contact our sales team for more details.

Equipment may include but is not limited to:

Electrical systems and equipment

Climate control / chilling equipment

Mechanical systems / equipment

Monitoring and secure systems

Emergency generators

Hardware / Software

Computers / Servers

Network connectivity equipment

Racks / Cabinets

Cabling

Raised floor systems

Other data center infrastructure equipment and systems necessary to operate

Installation, maintenance, repair, refurbishment, and replacement of qualified equipment

Equipment to generate, transform, transmit, distribute, or manage electricity necessary to operate

All other tangible personal property that is essential to the operations of a data center

Plus more

SF CH1 Services

Serverfarm CH1 customers benefit from on-site and remote services.

A top quality team of experts and support.

A top quality team of experts provide services from set up to commissioning to maintenance, monitoring and support throughout the entire data center operation lifecycle.

Using Serverfarm's **InCommand Services**, the cloud based platform for data center ME, OT and IT, infrastructure management, being tethered to service processes that are dictated by aging infrastructure is no longer necessary.

Serverfarm CH1 hosts the global central NOC for InCommand giving customers access to on-site experts for its services.



InCommand creates a cloud-like experience for any data center.

Photo by MILLER + MILLER Architectural Photography

InCommand Services

InCommand is Serverfarm's proprietary integrated platform, which gathers all physical assets in IT, facility and data center environments and presents them as a virtualized service - creating a cloud-like experience for data centers.

InCommand provides businesses with virtual control over their IT infrastructure, delivering the powerful insights needed to drive capacity planning, change management, life cycle management and increased day-to-day operational efficiency.

Using sensors and artificial intelligence-powered applications, InCommand monitors all customer infrastructure, aggregating data across devices in one portal.

True Data Center Management as a Service (DMaaS)

This is more than simply another data center management software layer. The platform combines people, processes and a portal to provide a managed services approach.

We believe this is the best way to deliver true Data Center Management as a Service (DMaaS) - not just DCIM delivered via cloud.



InCommand has proven the ability to increase infrastructure capacity utilization rates from 30% to 80%. It helped one organization save \$33 million in planned construction costs, while allowing one Fortune 300 company to save over \$22 million in CapEx and OpEx.

This latest iteration of InCommand introduces an elevated level of large-scale automation, with the platform aggregating data from multiple systems over long periods of time and providing trends and analytics that save companies millions when it comes to CapEx and OpEx.

Today's enterprise and service provider executives would rather spend resources on innovation, digital transformation and customer service, leaving data center management to experts who run these facilities day in and day out. InCommand is the fully managed solution to that growing market demand.

Now more than ever, the demand for an integrated cloud-based service platform such as InCommand is rapidly growing.



serverfarm™

About Serverfarm

Serverfarm is a unique IT and data center developer and operator with a pioneering approach to accelerating digital transformation for service providers and enterprises.

With InCommand Services, our integrated platform of real estate, data center and IT management solutions, we maximize our customers' infrastructure efficiencies, providing them with end-to-end visibility and control over their IT and data center environments. As a result, our customers and their teams gain agility, reliability and efficiencies, allowing them to focus on innovation.

For More Information

Corporate Office – Los Angeles
999 N. Pacific Coast Highway
Suite 600
El Segundo, CA 90245
+1.310.563.1700

Europe Office – London
Unit 4, Westgate Industrial Estate
Feltham TW14 8RS
United Kingdom
+44.2033.181575

sales@sfrdc.com // serverfarmllc.com